

PLANET CALLISTO/PLANET EUROPA/ PLANET TELESTO - DOWNLIGHTS

01.0527/01.0528/01.0529

GX53 MAX.13W 220~240V 50Hz

IP23	CLASS II		 Ø: 1.35MM	 H03VV-F 2 x Ø.75MM ² 6A30 x MAX.13W GX53	 H03VV-F 2 x 1.5MM ² 12A60 x MAX.13W GX53	 GX53 MAX.13W 220-240V~ 50Hz MEGAMAN®	

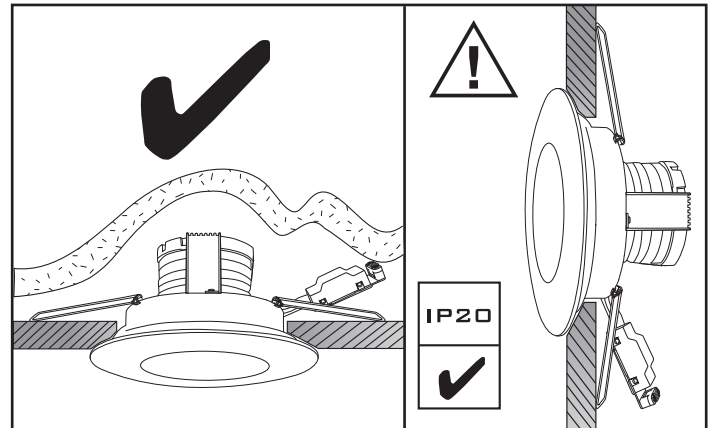
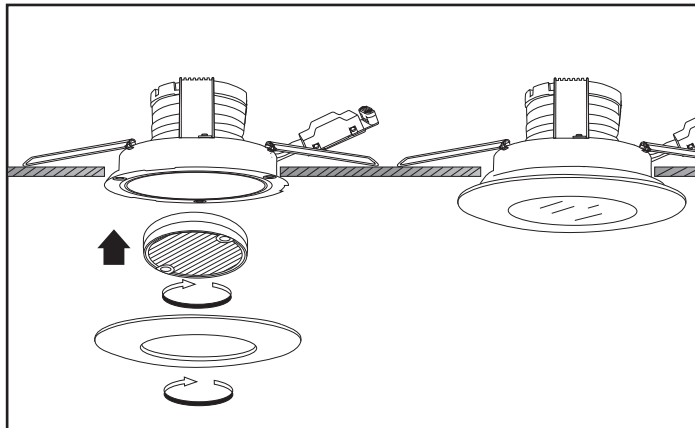
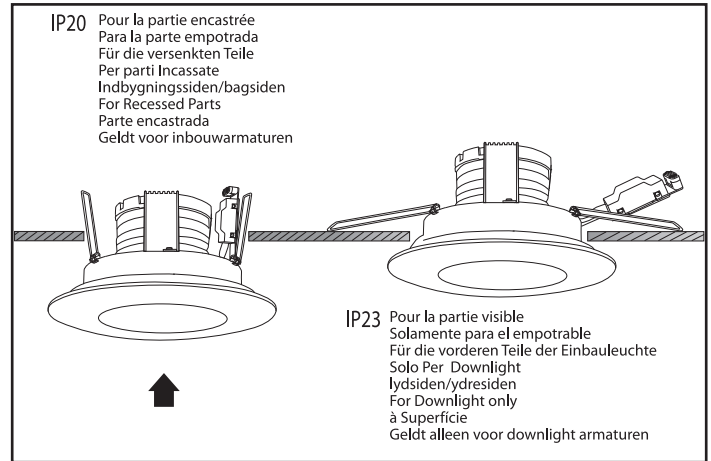
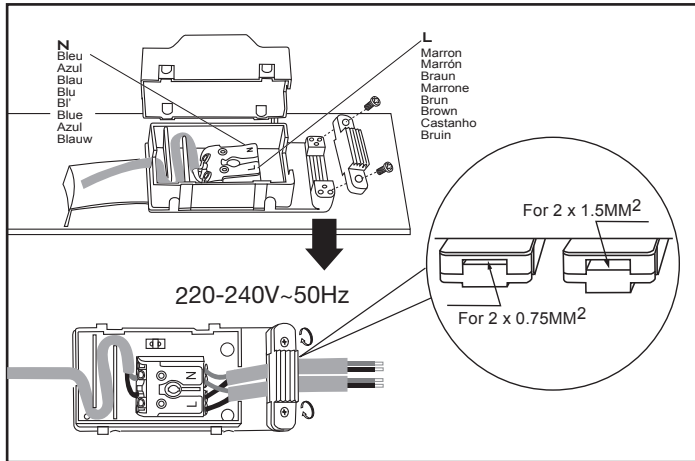

- (GB)**
- (1) Ensure that the main electrical supply is switched off before installing the fitting.
 - (2) For energy saving lamp only.
 - (3) Waste electrical products should not be disposed of with household waste. Please recycle where facilities exist. Check with your local authority or retailer for recycling advice.

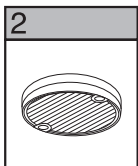

- (SE)**
- (1) Koppla av strömmen vid installation och lampbyte.
 - (2) Avsedd endast för energisparlampa. Tex Megaman energisparlampa.
 - (3) Får ej sorteras bland hushållsavfall. Lämnas in enligt anvisningar på återvinnings-station.

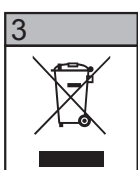

- (FI)**
- (1) Varmista, että valaisin on jännitteetön aina ennen asennusta tai lampunvaihtoa
 - (2) Suunniteltu vain energiansäästölampulle. Esim. Megaman -energiesäästölamput
 - (3) Vialliset ja vaurioituneet tuotteet on toimitettava valaisinkierrätyspisteisiin.