

**Tuotetiedot**

|            |  |             |                |             |                      |
|------------|--|-------------|----------------|-------------|----------------------|
| Tuotekoodi | <b>VC05-0393</b>                                       | Sähkönumero | <b>1914311</b> | EAN-koodi   | <b>6410019143119</b> |
| Tuotenimi  | OTL-liitin 3xAl/Cu 95-300mm <sup>2</sup> (Keltavihreä) |             |                | ETIM-luokka | <b>EC000897</b>      |
| Johtimet   | 3xAl/Cu 95-300mm <sup>2</sup>                          |             |                |             |                      |

**Tekniset tiedot**

|                       |                         |   |                 |
|-----------------------|-------------------------|---|-----------------|
| Nimellisvirta (IEC)   | Cu                      | <b>630</b>                                      | A               |
|                       | Al                      | <b>630</b>                                      | A               |
| Nimellisjännite (IEC) |                         | <b>1000 V AC / 1500 V DC</b>                    |                 |
|                       |                         | -   |                 |
|                       |                         | -   |                 |
| Napaluku              |                         | <b>1</b>  | kpl             |
| Max. Johdinkoko       |                         | <b>300</b>                                      | mm <sup>2</sup> |
| Kiristysmomentti      |                         |   |                 |
|                       | 95-150 mm <sup>2</sup>  | <b>35</b>                                       | Nm              |
|                       | 185-300 mm <sup>2</sup> | <b>45</b>                                       | Nm              |
|                       |                         | -   |                 |
|                       |                         | -   |                 |
| Min. Asennuslämpötila |                         | <b>+5</b>                                       | °C              |
| Käyttölämpötila       |                         | <b>-25...+80</b>                                | °C              |
| Paino                 |                         | <b>680</b>                                      | g               |
| IP-suojaus            |                         | <b>IP20</b>                                     |                 |
| Standardit            |                         | <b>EN 61238-1:2003</b>                          |                 |
| Väri / Materiaali     |                         | <b>Green RAL 6018, Yellow RAL 1016/ PA66-V0</b> |                 |
| Kiinnitys / Kytkenä   |                         | <b>DIN-kiskokiinnitys ja ruuvikiinnitys M5</b>  |                 |

**Kuvaus**

OTL-yleisliittimet ovat tarkoitettu alumiini- ja kuparikaapeleiden liittämiseen ja haaroittamiseen. Liitinrunko on tinapinoitettua alumiinia. Kotelointi on valmistettu UL94 V0 -luokan polyamidista. Valmistettu Suomessa.

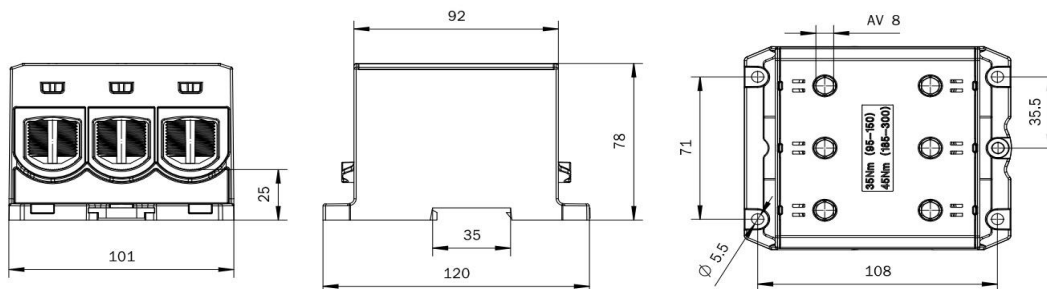
**Mittakuva**

**Pakkaus**

|              |                 |               |            |              |             |
|--------------|-----------------|---------------|------------|--------------|-------------|
| Pakkausmuoto | <b>Laatikko</b> | Kpl / Pakkaus | <b>1</b>   | Paino [kg]   | <b>0,80</b> |
| Pituus [mm]  | <b>165</b>      | Leveys [mm]   | <b>110</b> | Korkeus [mm] | <b>150</b>  |

**Ouneva Oy**

Teollisuustie 21  
FI-82730 Tuupovaara  
Finland

[www.ounevagroup.fi](http://www.ounevagroup.fi)
[www.ounevaproductions.fi](http://www.ounevaproductions.fi)

**Product data**

|              |  |          |                |            |                      |
|--------------|--|----------|----------------|------------|----------------------|
| Product code | <b>VC05-0393</b>   | STK-code | <b>1914311</b> | EAN-code   | <b>6410019143119</b> |
| Product name | OTL-connector 3xAl/Cu 95-300mm <sup>2</sup> (Yellow/Green) |          |                | ETIM class | <b>EC000897</b>      |
| Wires        | 3xAl/Cu 95-300mm <sup>2</sup>                              |          |                |            |                      |

**Technical data**

|                               |   |                  |                 |
|-------------------------------|---|------------------|-----------------|
| Nominal current (IEC)         | Cu  | <b>630</b>       | A               |
|                               | Al  | <b>630</b>       | A               |
| Nominal voltage (IEC)         | <b>1000 V AC / 1500 V DC</b>                    |                  |                 |
|                               |   | -                |                 |
|                               |   | -                |                 |
|                               |   | -                |                 |
| Number of poles               |   | <b>1</b>         | pcs             |
| Max. Cross section            |   | <b>300</b>       | mm <sup>2</sup> |
| Tightening torque             |   |                  |                 |
|                               | 95-150 mm <sup>2</sup>                          | <b>35</b>        | Nm              |
|                               | 185-300 mm <sup>2</sup>                         | <b>45</b>        | Nm              |
|                               |   | -                |                 |
|                               |   | -                |                 |
| Min. installation temperature |   | <b>+5</b>        | °C              |
| Operating temperature         |   | <b>-25...+80</b> | °C              |
| Weight                        |   | <b>680</b>       | g               |
| IP-protection                 |   | <b>IP20</b>      |                 |
| Standards                     | <b>EN 61238-1:2003</b>                          |                  |                 |
| Color / Material              | <b>Green RAL 6018, Yellow RAL 1016/ PA66-V0</b> |                  |                 |
| Mounting / Connection         | <b>DIN rail and screw (M5) mounting</b>         |                  |                 |

**Description**

OTL-connectors are designed for connecting and branching aluminium and copper conductors. The body is made of tin plated aluminium. Housing is made of UL94 V0 class polyamide.

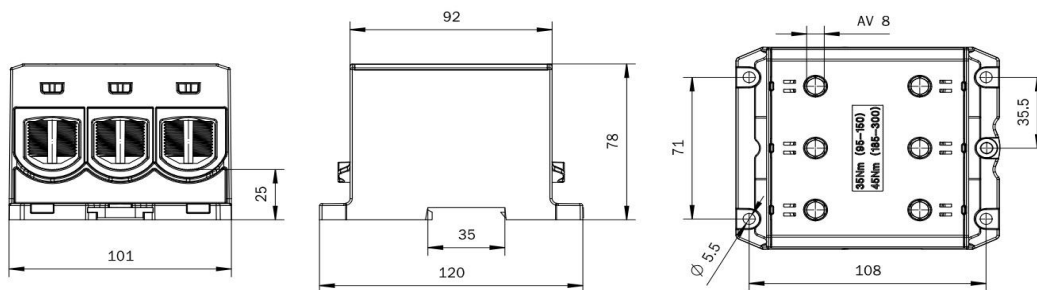
**Drawing**

**Package**

|             |            |               |            |             |             |
|-------------|------------|---------------|------------|-------------|-------------|
| Package     | <b>Box</b> | Pcs / Package | <b>1</b>   | Weight [kg] | <b>0,80</b> |
| Length [mm] | <b>165</b> | Width [mm]    | <b>110</b> | Height [mm] | <b>150</b>  |

**Ouneva Oy**

Teollisuustie 21  
FI-82730 Tuupovaara  
Finland

[www.ounevagroup.fi](http://www.ounevagroup.fi)

[www.ounevaproducts.fi](http://www.ounevaproducts.fi)