

Lampholders and starter holders

26.291.5012

G13 Push through lampholders

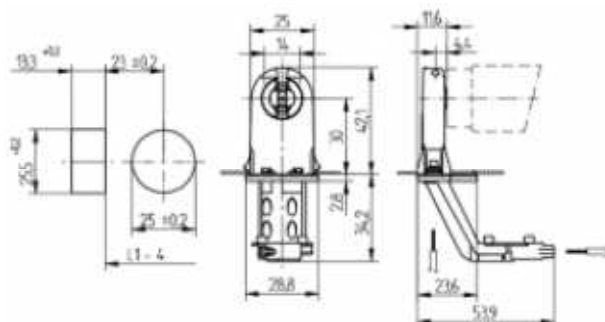

L1-4: Recommended dimension - The distance between the cut-outs and the tolerance should be governed by the dimensions of the respective lamps and luminaires.

colour	pkg.	wt.	part no.
white	250	10 g	26.291.5012.50

With starter holder

Approval: additional cULus (660W /600V)

Lamp centre: 30 mm

Push fixing

Housing: PC

Rotor: PBT

- For enclosed cut-outs
- A pair of lampholders provides a lamp length tolerance compensation of 3 mm

T 130	Tm 110							
						18 AWG 0.5 -1.0 mm ²	0.4 - 2.0	90°