

# SONIC MEDIUM MAST

220-240V LED 38W IP68

EN: MOUNTING  
 NO: MONTERING  
 SE: MONTERING  
 FI: ASENNUS

1

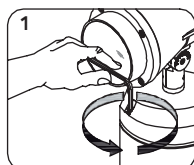
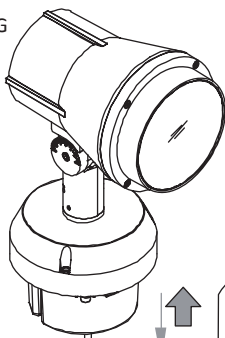

\*

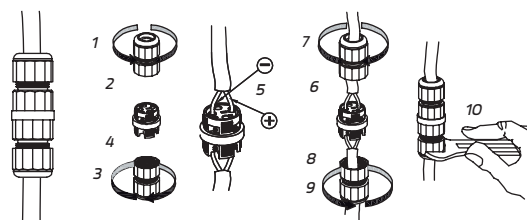
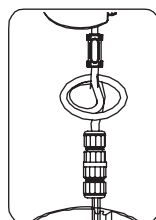

2 ↑

\*

 **EN:** Do not cut or disconnect the cable between this area.  
**NO:** Ikke kutt eller koble kabelen fra dette området.  
**SE:** Skär inte eller koppla ut kabeln mellan detta område.  
**FI:** Älä leikkaa tai irrota kaapeli tältä alueelta.

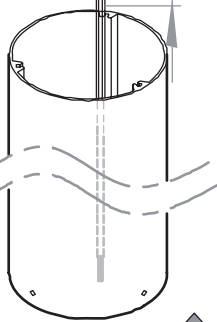

4 ↑

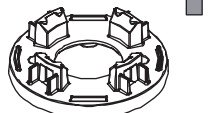

2

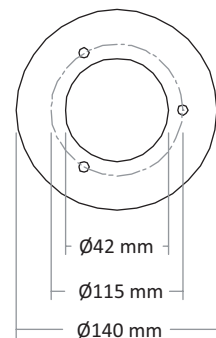
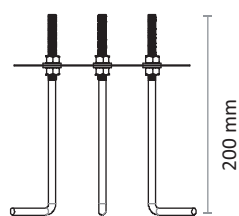
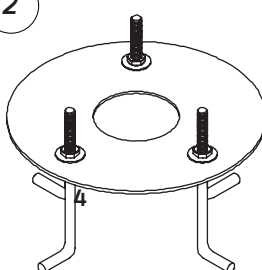

200 mm

3

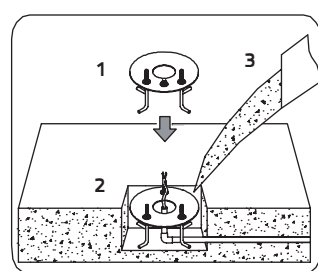
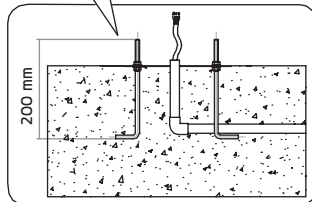
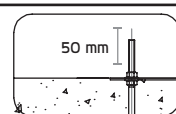

4

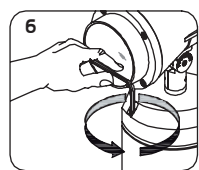
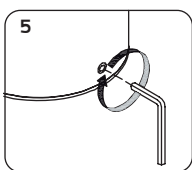
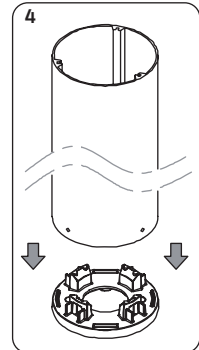
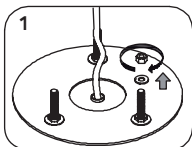
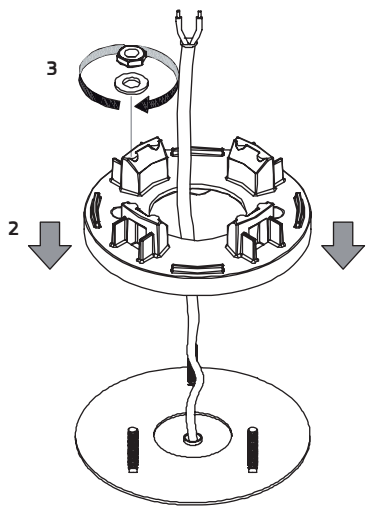

5

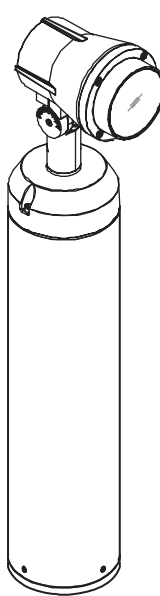

EN: MEASUREMENTS  
 NO: MÅL  
 SE: MÅTT  
 FI: MITAT

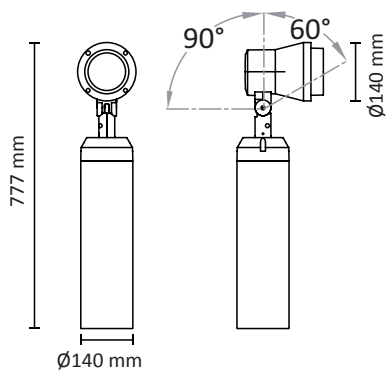

**OBS!** EN: Installation must be performed by a qualified electrician.  
 NO: Må installeres av autorisert el-installatør.

SE: Måste installeras av en behörig elinstallatör.  
 FI: Vain valtuutettu sähköasentaja saa asentaa.

EN: ADJUSTABLE OPTIC UNIT  
NO: JUSTERBAR OPTISK ENHET  
SE: JUSTERBAR OPTISK ENHET  
FI: SÄÄDETTÄVÄ OPTINEN YKSIKKÖ

1

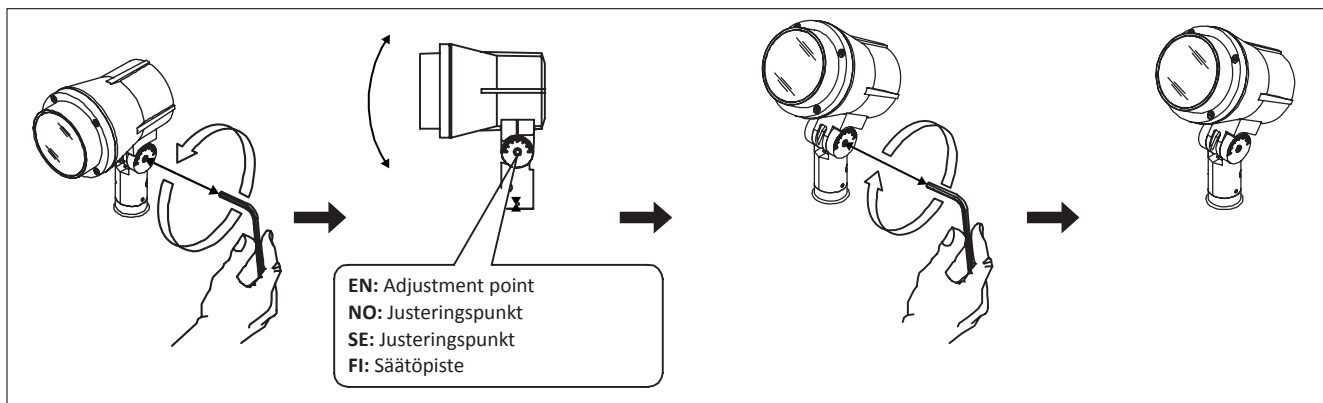

2

