

INSTALLATION AND USER GUIDE FOR WARMOS RADIATORS

GENERAL INFO

All Warmos radiators are made in Finland, they have been awarded the Finnish Key Flag Symbol and they have CE marking. The frames are manufactured of high-quality cold-rolled steel DC01-AM0. The heater oil is non-freezing and has a pour point of -42 °C, so the heater will not be damaged and will remain in working condition even if left in cold conditions for a long time. The heaters have durable powder coating. The basic colour is white RAL9010, but other colours are available on request. They do not burn dust or electrify air, which makes them suitable for people with dust allergy and electromagnetic hypersensitivity.

SAFETY

Warmos heaters conform to the safety standards EN 60335-1 and EN 60335-2-30. They can be used by children aged from 8 years and above and persons with reduced physical, sensory or mental capabilities or lack of experience and knowledge if they are supervised and have been given instructions concerning the use of the appliance in a safe way and understand the hazards involved. Children must not play with the appliance. Cleaning and user maintenance shall not be made by children unless they are older than 8 years and are supervised. Children under 8 years must not plug in the cord, adjust the temperature, clean nor maintain the appliance. Keep the appliance and its power cord out of reach of children aged less than 8 years.

Electrical installation must be performed according to the applicable national standards and regulations. Fixed wall-mounting must be carried out by a qualified professional electrician. Electrical installation must be performed according to the wiring instructions. The heaters must be connected to the electrical supply only by using the supply cable fitted to the heater. All Warmos heaters have an overheating trigger which switches off the electric current if the surface temperature rises too high. The insulation class of Warmos heaters is 1 but the ingress protection rating varies by the model.

WARNING

Do not cover the heater to avoid overheating. Do not place clothes directly on the radiator to dry them. Do not place the heater underneath an electrical socket.

MAINTENANCE AND REPAIR

When properly positioned and installed Warmos heaters are durable and long-lasting and do not require actual maintenance. However, if you carry out maintenance operations, always disconnect electrical supply first. We recommend wiping dust and other impurities off the heater surface from time to time. The surface can be wiped with a damp cloth. Do not use chemical or abrasive cleaners as they will damage the surface finish. If the supply cord or the thermostat is damaged, contact the manufacturer or a qualified professional electrician. The heaters are filled with a precise quantity of special oil. Repair work requiring the opening of the oil container and removal of the heating element are only to be made the manufacturer or their service agent. Manufacturer must be contacted if an oil leak occurs. In case of an emergency, contact the manufacturer or a qualified professional electrician.

DISPOSAL

Warmos heaters must be disposed according to the WEEE directive 2002/96/EC. The heaters may not be handled as domestic waste, they must be sorted separately. When the heaters reach the end of their useful life, they shall be returned to a collection facility for electrical and electronic products, and regulations concerning the disposal of oil must be followed. Warmos is a member of Elker, a service company for organizing the collection and recycling of WEEE in Finland. Warmos fulfills its producer responsibility obligations through Elker. Electrical products are subject to a recycling fee, which Warmos pays for all its products. Consumers can take Warmos products to a recycling facility free of charge.

WARRANTY

All Warmos heaters have a 10-year frame warranty. Electrical components are covered by a 2-year warranty.

FURTHER INFORMATION

More information on Warmos heaters and company is on our website **warmos.fi**. You can also scan the below QR codes to reach the Warmos product sites.



Walo series



Warma series



Wahva series



Wieras series



Werstas series

Thank you for choosing Warmos!

WALO, WARMA AND WAHVA HEATERS WITH FIXED WALL MOUNTING (IP34, 230V, 50Hz)

The trendy 20cm high Walo, stylish 40cm high Warma and timeless 60cm high Wahva heaters are all wall-mounted and they are connected to a junction box with a 5-pole plug-in connector. Their ingress protection rating is IP34 which makes them splash-proof, but their junction box is drip-proof IP21. If a higher IP rating is required, the 5-pole plug-in connector can be removed and the electrical connection can be made in an IP44 rated junction box with membrane cable glands. The insulation class is 1. The heater is supplied with wall brackets and a junction box. The heaters conform to the following directives and standards:

Safety standard EN60335-1 and EN 60335-2-30

RE directive 2014/30/EU

Restriction of hazardous substances directive (RoHS II) 2011/65/EU

Ecodesign directive 2009/125/EC + 2015/1188/EU

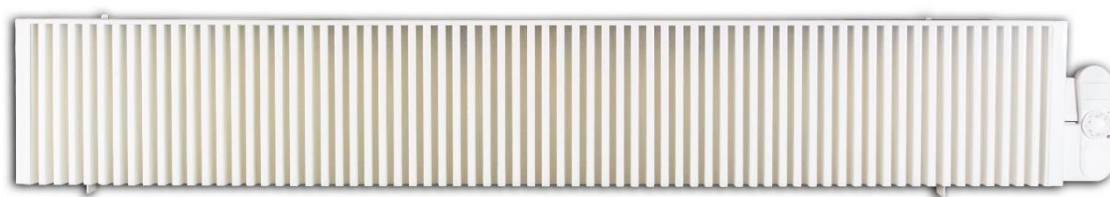

Series and model	Width mm	Height mm	Power W	Brackets' mounting hole distance mm	Product no.
Walo					
EW205	600	200	500	305	8123903
EW208	1000	200	800	590	8123904
EW210	1300	200	1000	790	8123905
EW212	1600	200	1200	935	8123907



Series and model	Width mm	Height mm	Power W	Brackets' mounting hole distance mm	Product no.
Warma					
EW402	360	400	200	125	8123909
EW403	560	400	350	325	8123911
EW405	720	400	500	405	8123913
EW408	1120	400	800	720	8123914
EW410	1440	400	1000	965	8123915
EW412	1720	400	1250	1160	8123916
Wahva					
EW605	560	600	500	405	8123920
EW608	880	600	800	560	8123921
EW610	1120	600	1000	720	8123922
EW612	1440	600	1250	965	8123924
EW615	1720	600	1500	1160	8123926

Wall mounting

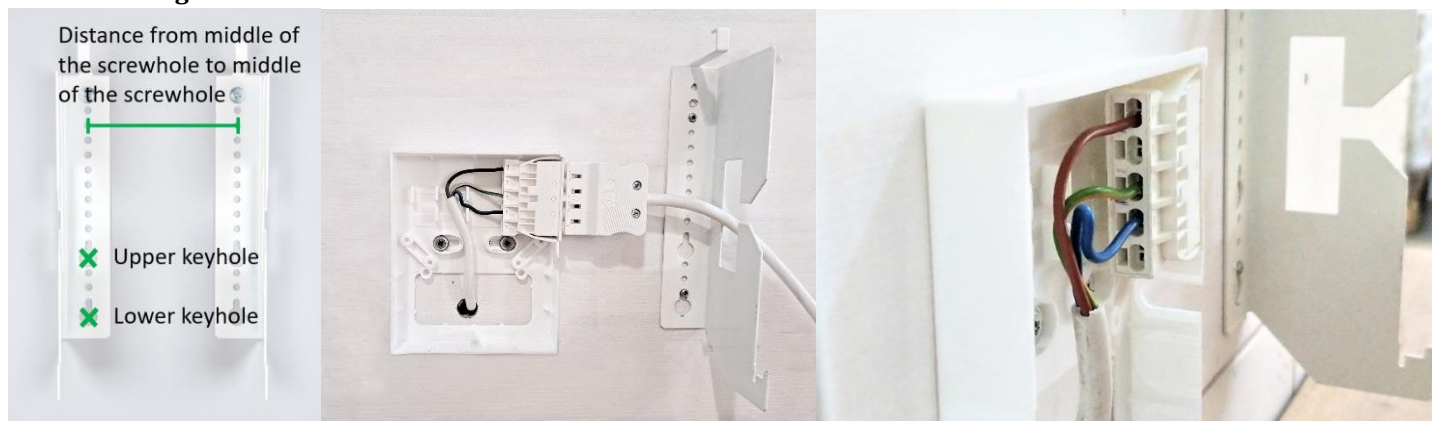

Note safety distances when mounting the heater on a wall. The safety distance is 50mm on each side and 100mm upwards and forwards. The recommended minimum height is 50mm off the floor. The thermostat adds 50mm to the width. The distance from the wall to the front surface of Walo heaters is 110mm and 75mm to the front surface of Warma and Wahva heaters, when the wall brackets are in place, but 100mm to the thermostat's front surface. Follow the local regulations and other applicable standards when placing the heater in damp locations. The heater must be fixed to the wall using the supplied wall brackets. Do not position the heater underneath an electrical socket. Make sure that the wall type, material and condition are suitable for fixing the heater.

Asuinkiinteistöjen kylpy- ja suihkutilojen alueet ja sähkölaitteiden etäisyydet SFS 6000:n (2017) mukaan

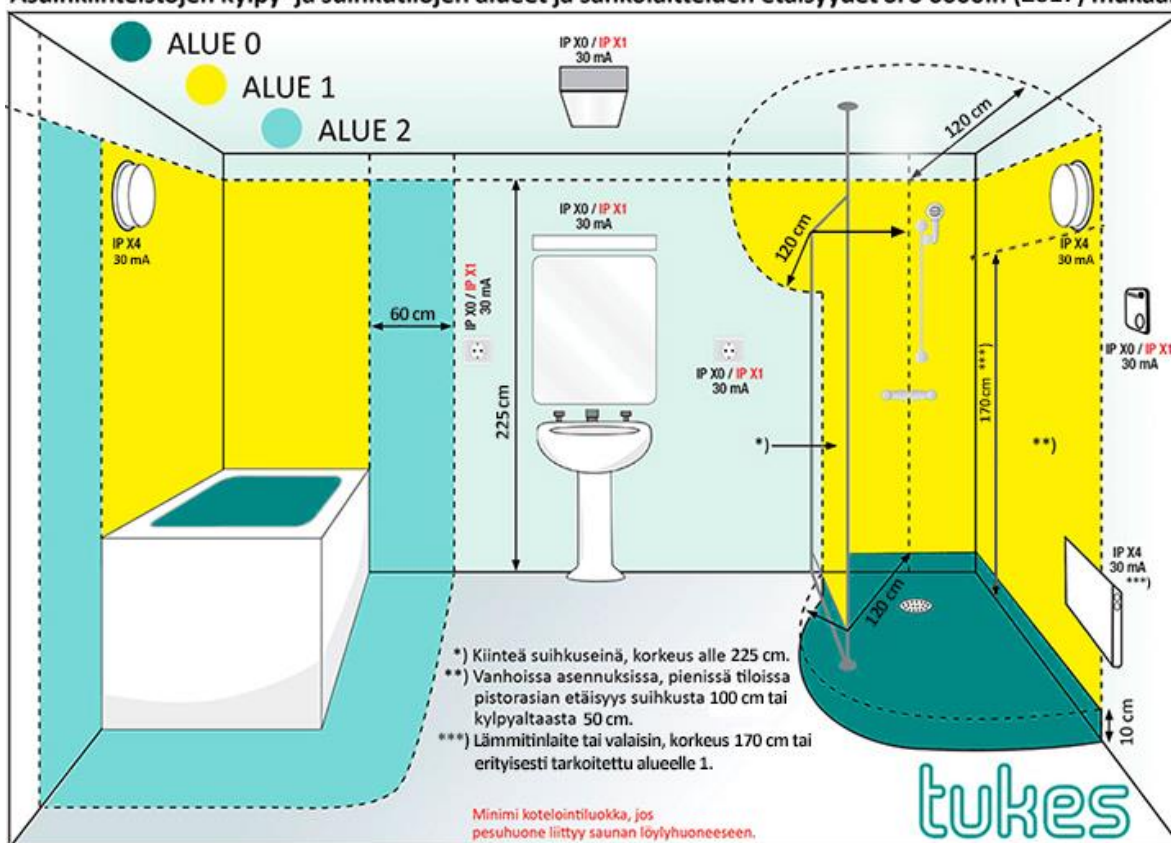

- 1) Place the heater on the floor against the wall with wall brackets in place.
- 2) Check the correct mounting location. Mark the locations of the top ends of the wall brackets on the wall.
- 3) Remove the brackets off the heater and place them upright on the floor to the points you marked.
- 4) Tighten the screw in the upper big fastening hole of the left bracket standing on the floor against the wall.
- 5) Remove the bracket and set it to rest on the screw by the lower keyhole of the bracket. Tighten the upper screws.
- 6) Repeat the same for the right-hand bracket. The heater is now placed a minimum of 50mm off the floor, as recommended.
- 7) Mount the junction box to the wall according to the following instructions. Then place the heater in the wall brackets horizontally.

Electrical connection

If the heater is installed in a bathroom or shower room, it must be protected with a residual current device (RCD) with a rated residual current not exceeding 30 mA. When installing a heater in a shower room or sauna, consult a qualified professional electrician.

Install the junction box on the wall behind the heater. The recommended height of the junction box's center is approximately 120mm off the floor. The input tube should be positioned at approximately 100mm off the floor. The wall brackets have a hole for the power cord. Place the cord in the hole and roll up the possible extra cord. This way the cord is neatly behind the heater. The electrical wiring diagram contains wiring instructions.

Heaters placed in one room can be parallelly installed. One master heater steers the other heaters. The combined power of the master and parallel heaters must not exceed 2300 Watts. If a heater is parallelly mounted, the master heater's junction box connector no. 3 is connected to the parallel heater's connector no. 1. Walo, Warma ja Wahva heaters can be made into parallel heaters by turning the control knob into its extreme position, by taking off the knob and then replacing it with the empty knob cover that is supplied with the junction box. Also a slave unit without its own thermostat is available. It is connected in the same way.

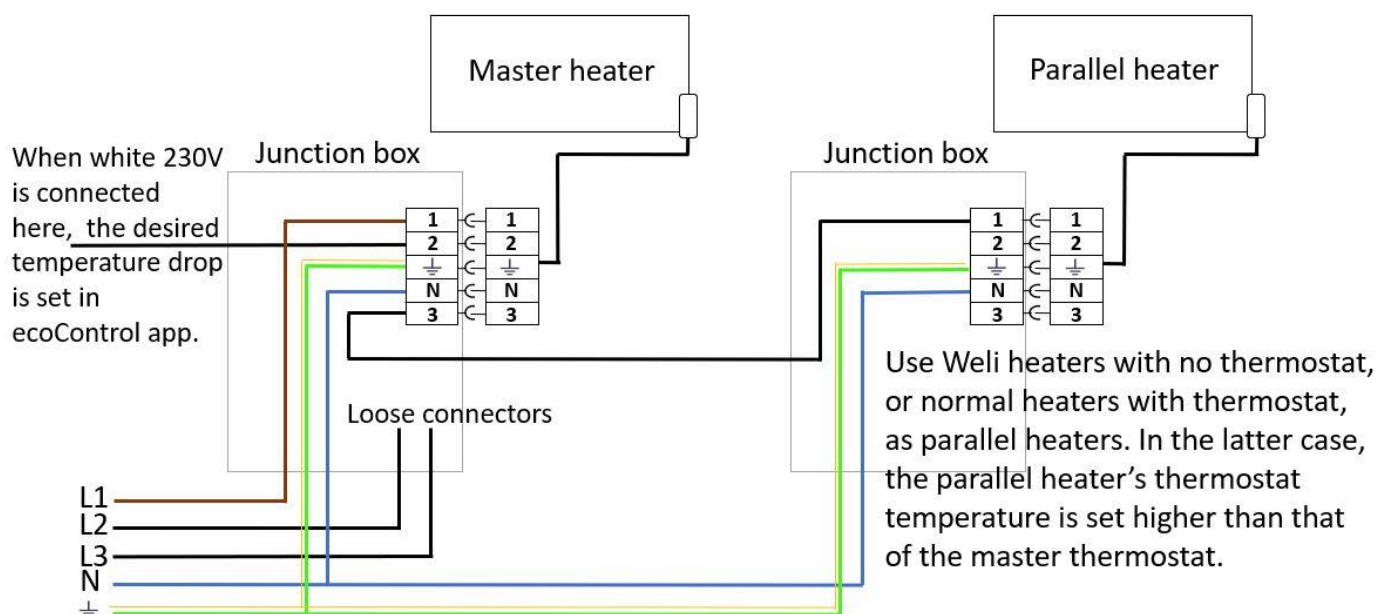

Electrical wiring:

- Yellow-green is protective grounding.
- Blue is working zero N.
- Brown is heater's input supply 230V 50Hz to the connector no. 1.
- Black is the input supply of the master heater to the parallel heater's connector 230V no. 3.
- White is the temperature change/drop from current temperature when 230V is supplied to connector no. 2 (any line to neutral voltage is suitable (L1, L2 or L3)).
- The protective grounding of the parallel heater is normally connected to the neutral conductor.
- Black no. 3 of the master thermostat is connected to the brown no. 1 of the parallel heater.

If the building has a Home/Away -switch or similar temperature drop control, it can be connected to connector 2. When the connector is activated, the temperature will drop from the Home mode to a lower Away mode. The preset value for temperature drop is 19 °C. The settings can be adjusted in the ecoControl application which is described in more detail below.

Operation

Switch the power on to position I on the O/I switch. It will take approximately 15 seconds for the thermostat to load itself, so there is a slight delay in the light turning on. Set the desired temperature on a scale of 5-35 °C. If the heater's power is appropriate for the space, the thermostat will keep the temperature stable.

When the thermostat's green LED light is steadily lit up, the heater is heating. When the heater has reached the set temperature, the light will turn off. When the light is blinking slowly, it is paired with the ecoControl app or the drop temperature is on. When the light is blinking fast, the thermostat is waiting for the confirmation of the set values in the ecoControl app.

A mounting bracket has a tilting piece which allows you to vacuum-clean the backside of the heater. When lifting the heater off the wall brackets, remember to turn off the heater first. A child protective button cover prevents children from adjusting the thermostat temperature.

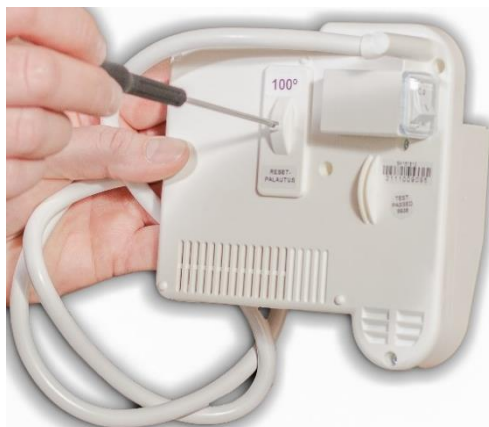

The heater must not be covered. If the surface temperature rises too high due to it being covered, for example, the overheating trigger switches off the electric current of the heater at 100 °C, and the heater starts to cool off. Let it cool off, then tilt it and push the reset button at the back side. Your heater is fully functional again. If the heater will not start to heat up again, contact the manufacturer.

EcoControl

ecoControl is a smart device application. The application allows you to monitor and control the EW thermostats of Warmos Walo, Warma and Wahva radiators. ecoControl application and the Bluetooth controllable EW Ecodesign thermostat form an easy-to-use and cost-effective pair that complies with the strict EU Ecodesign directive. Download the app free of charge from Google Play or App Store by searching with the word “ecoControl” or by using the QR codes below.

Turn on the Bluetooth on your phone. Launch the application and select the desired language from the app settings icon on the Home screen. Connect your phone to the thermostat. You will find more detailed instructions in the application. See “Get support” button. With the application you can do the following:

- adjust temperature drop values on an hourly basis for a week
- adjust temperature values for a separate Home/Away switch
- select another temperature range for the control knob
- calibrate the thermostat
- limit the heater's output power
- adjust the brightness of the thermostat led
- view temperature history
- limit the temperature values so that they cannot be changed by turning the thermostat knob

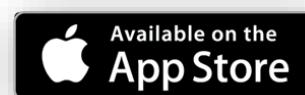

MANUFACTURER

Warmos Heating Ltd
Muurlantie 510
FI-25130 Muurla
P. +358 44 7217112
info@warmos.fi
www.warmos.fi